

ids Plugin GSM Modem



**INSTALLATION &
OPERATION MANUAL**

GETTING STARTED

1. Connect the IDS Plugin to the Alarm Panel

See the appropriate section for the Alarm Panel on the next page

2. Help with installing the ArmME app on a customer's mobile device

Refer to the ArmME Installation Guide



Scan QR code
to download
the ArmME app



TABLE OF CONTENTS

| | |
|------------------------------------|---|
| 1. INTRODUCTION | 4 |
| 2. THE ArmME APP | 5 |
| 3. IDS X-SERIES PANEL SET UP | 6 |
| 4. IDS 806 PANEL SET UP | 9 |

APPENDIX A

| | |
|----------------------------|----|
| FEATURES & FUNCTIONS | 11 |
|----------------------------|----|

1. INTRODUCTION

The IDS Plugin GSM Modem Wi-Fi is a highly-featured Wi-Fi and GSM-based unit which is used for the secure transmission of alarm signals to a control room.

The IDS Plugin GSM Modem Wi-Fi unit will communicate messages to the control room using the Wi-Fi network. The GSM network will then become the secondary means of communication in case of Wi-Fi connectivity issues.

The IDS Plugin GSM Modem Wi-Fi has a serial interface to all IDS Alarm panels.

2. THE ArmME APP

Please note the following:

1. The IDS Plugin GSM Modem Wi-Fi can only be set up to connect to a Wi-Fi network via the ArmME app.
2. Make sure the IDS Plugin GSM Modem Wi-Fi is connected to the GSM network before setting up the Wi-Fi network connection.

The ArmME App is available for the customer to download, should they wish to remotely control their alarm panel.

If you are helping the customer set up the ArmME App on his or her phone, please refer to the ArmME Installation Guide.

3. IDS X-SERIES PANEL SET UP

3.1 CONNECTING THE IDS PLUGIN GSM MODEM WI-FI TO THE PANEL

N.B. Make sure the firmware on the IDS X-Series panel has been upgraded to V2.50 or later.

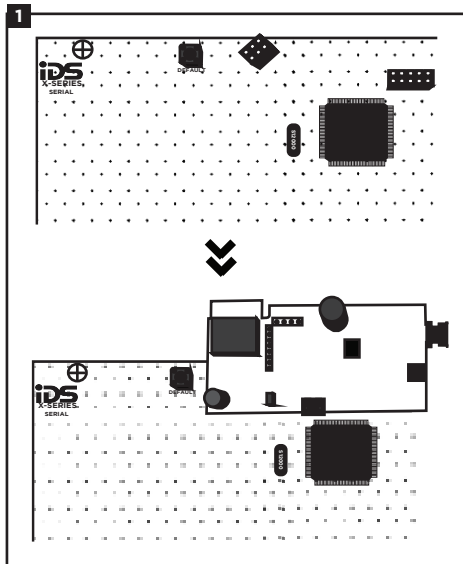

1. Plug the unit into the expansion connectors on the IDS alarm panel as shown.

3.2 PANEL PROGRAMMING FOR APP CONNECTION

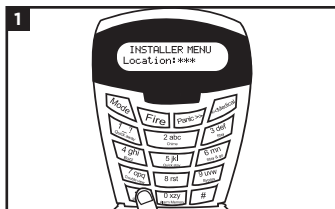

1. Enter the installer code (default 9999) into the keypad followed by [*] to go into the Installer Menu.

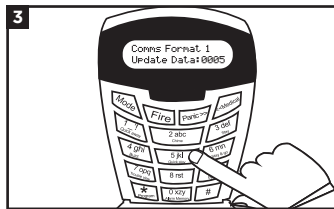

3. Enter [041] followed by [*]. Select Contact ID as the communication format by pressing [5] and then [*] to save

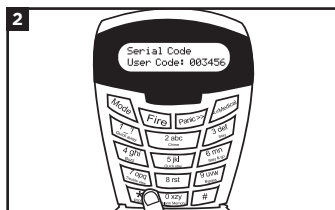

2. Enter [196] followed by [*]. Enter the serial code: 003456 and press [*] to save.

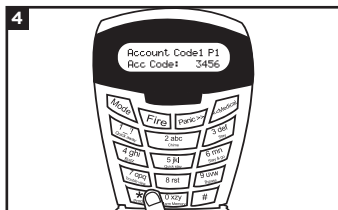

4. To program partition account codes go to locations 61-68 depending on the number of partitions. For the first partition, enter [061] followed by [*]. Enter any 4 digit account code e.g. [3456] followed by [*] to save. If there are more partitions being used, repeat this step e.g. for partition 2 enter location [062] followed by the account code and [*] to save, etc.

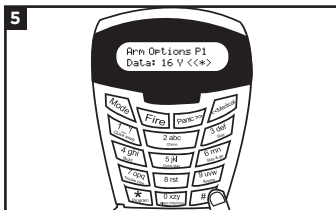

5. Enable opening and closing reporting for each partition by going to locations 211-218. For partition 1, enter [211] followed by [*]. Scroll to option [16] by using the scroll buttons indicated by double arrows (<<, >>). Set option [16] to yes (Y) by pressing [*]. Press [#] to return to the main Installer Menu. For more than one partition repeat this step e.g. for partition 2, enter location [212], set option [16] to yes (Y) by pressing [*] to save, etc. .

4. IDS 806 PANEL SET UP

4.1 CONNECTING THE IDS PLUGIN GSM MODEM WI-FI TO THE PANEL

PLEASE NOTE:

1. On the IDS806 alarm panels with 1.8x firmware version range, the ArmME app is compatible with panel firmware version 1.85 or later.
2. On the IDS806 alarm panels with 1.1x firmware version range, the ArmME app is compatible with panel firmware version 1.12 or later.

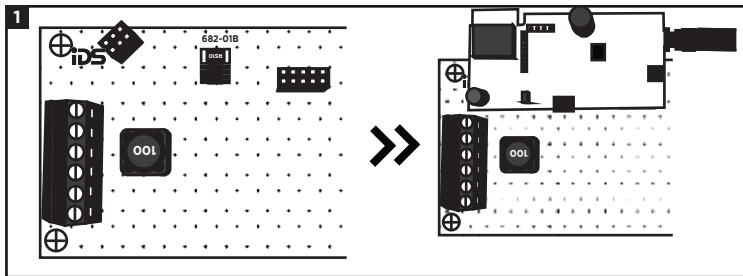

1. Plug the unit into the expansion connectors on the IDS Panel as shown.

4.2 PANEL PROGRAMMING FOR APP CONNECTION

VERY IMPORTANT: DO NOT install the IDS Plugin GSM Modem Wi-Fi unit to the alarm panel before or in the middle of panel programming as new programming settings will NOT be saved by the panel. Make sure the Plugin is installed AFTER programming of the panel has been concluded.

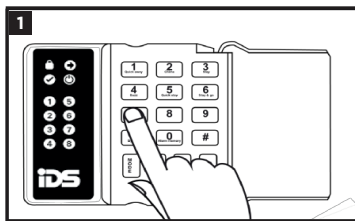

1. Enter the installer code (default 9999) into the keypad followed by [*] to go into the Installer Menu.

2. Program the 4-digit partition account code by going to locations 43-46. For the first digit, enter [43] followed by [*]. Enter the first digit of the account code e.g. [3] followed by [*] to save. To program the second digit, enter [44] followed by [*]. Enter the second digit of the account code followed by [*]. Do the same for the third and fourth digits in locations 45 and 46 respectively.

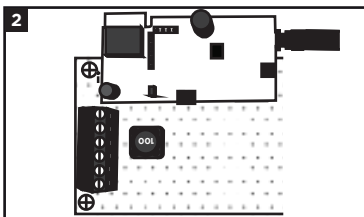

3. Press [#] to exit the Installer Menu.

4. Lastly, connect the IDS Plugin GSM Modem Wi-Fi unit to the IDS 806 panel.

APPENDIX A

FEATURES & FUNCTIONS

Reporting Options

- Wi-Fi reporting to the control room when Wi-Fi is set up in the ArmME app
- Fallback to LTE GSM reporting in case of Wi-Fi connectivity issues
- Roaming SIM card with multiple network fallbacks for enhanced GSM reliability

Programming

- Full programming and software updating via a computer serial port
- Programming over-the-air

Indicators and Controls

- Status LEDs
 - GSM Status Green - Connected
 - Wi-Fi Status Blue - Connected
 - Power Status Green - Power OK

LIMITED WARRANTY

Limitations of security products: Security products and alarm systems do not offer guaranteed protection against burglary, fire, or other emergencies. They may fail to warn for diverse reasons, including (but not limited to): power failure, dead batteries, improper installation, coverage “blind spots”, coverage areas overlooked during installation, defeat by technically sophisticated intruders, component failure, or inadequate maintenance.

Alarm systems should be checked weekly to ensure that all devices are working properly. AN ALARM SYSTEM IS NOT A SUBSTITUTE FOR INSURANCE.

FSK Electronics (Pty) Ltd warrants its products to be in conformance with its own plans and specifications and to be free from defects in materials and workmanship under normal use and service for twelve months from the date of original purchase. Seller's obligation shall be limited to repairing or replacing, at its option, free of charge for materials or labour, any part of which is proved not in compliance with seller's specifications or proves defective in materials or workmanship under normal use and service. Seller shall have no obligation under this Limited Warranty or otherwise if the product is altered or improperly repaired or serviced by anyone other than Seller. For warranty service, return transportation prepaid, to the manufacturer.

There are no warranties, expressed or implied, of merchantability, or fitness for a particular purpose or otherwise, which extend beyond the description on the face hereof. In no case shall seller be liable to anyone for any consequential or incidental damages for breach of this or any other warranty, express or implied, or upon any other basis of liability

whatsoever, even if the loss or damage is caused by its own negligence or fault.

Seller does not represent that the products it sells may not be compromised or circumvented; that the products will prevent any personal injury or property loss by burglary, robbery, fire or otherwise; or that the products will in all cases provide adequate warning or protection. Customer understands that a properly installed and maintained alarm system may only reduce the risk of a burglary, robbery, or fire without warning, but it is not insurance or a guarantee that such will not occur or that there will be no personal injury or property loss as a result.

Consequently, seller shall have no liability for any personal injury; property damage or other loss based on a claim the product failed to give any warning. However, if the seller is held liable, whether directly or indirectly, for any loss or damage arising under this limited warranty or otherwise, regardless of cause or origin, seller's maximum liability shall not in any case exceed the purchase price of the product, which shall be the complete and exclusive remedy against seller.

This warranty replaces any previous warranties and is the only warranty made by seller on this product. No increase or alteration, written or verbal, of the obligations of this limited warranty is authorised.

Note: Specifications are subject to change without notice. Patents issued and pending worldwide.



sales@amecor.com
support@amecor.com



www.fsk.co.za
www.armme.app



+27 11 477 2600
+27 11 477 7705 (technical support)
+27 82 657 7852 (emergency contact)



Amevor House, 14 Richard Road,
Industria North, 1709

